



by *semihandmade*

# Self Measuring Guide

Tips to easily take measurements for your BOXI project







Photographer: @elizabethmessina  
Designer: @citysage

---

# Introduction

To get your BOXI design started, we'll need a basic sketch of the floor plan (hand-drawn, computer, etc).

**This guide will provide useful tips on how to easily take measurements for your kitchen, bathroom, or any room.**



---

# Step 1: Your floor plan

## Measurements

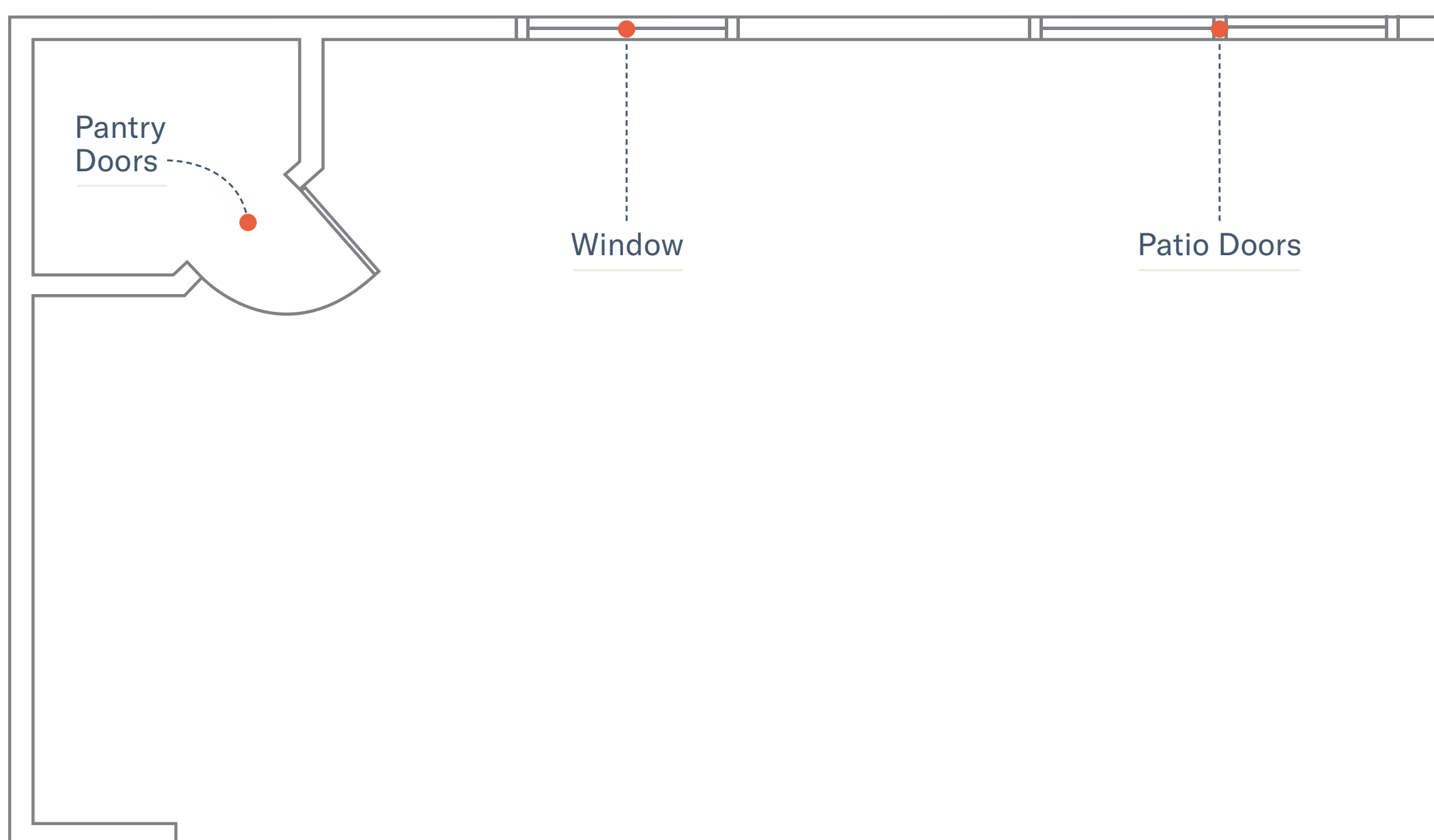

Create your floor plan by drawing a rough outline of your space including doors, windows, walkways, and any other openings you have in the room. Label each clearly.

Be sure to include any major structural features or obstacles that affect where the cabinets can be installed (posts, steps, etc).

## Step 2: Measure

### Measurements

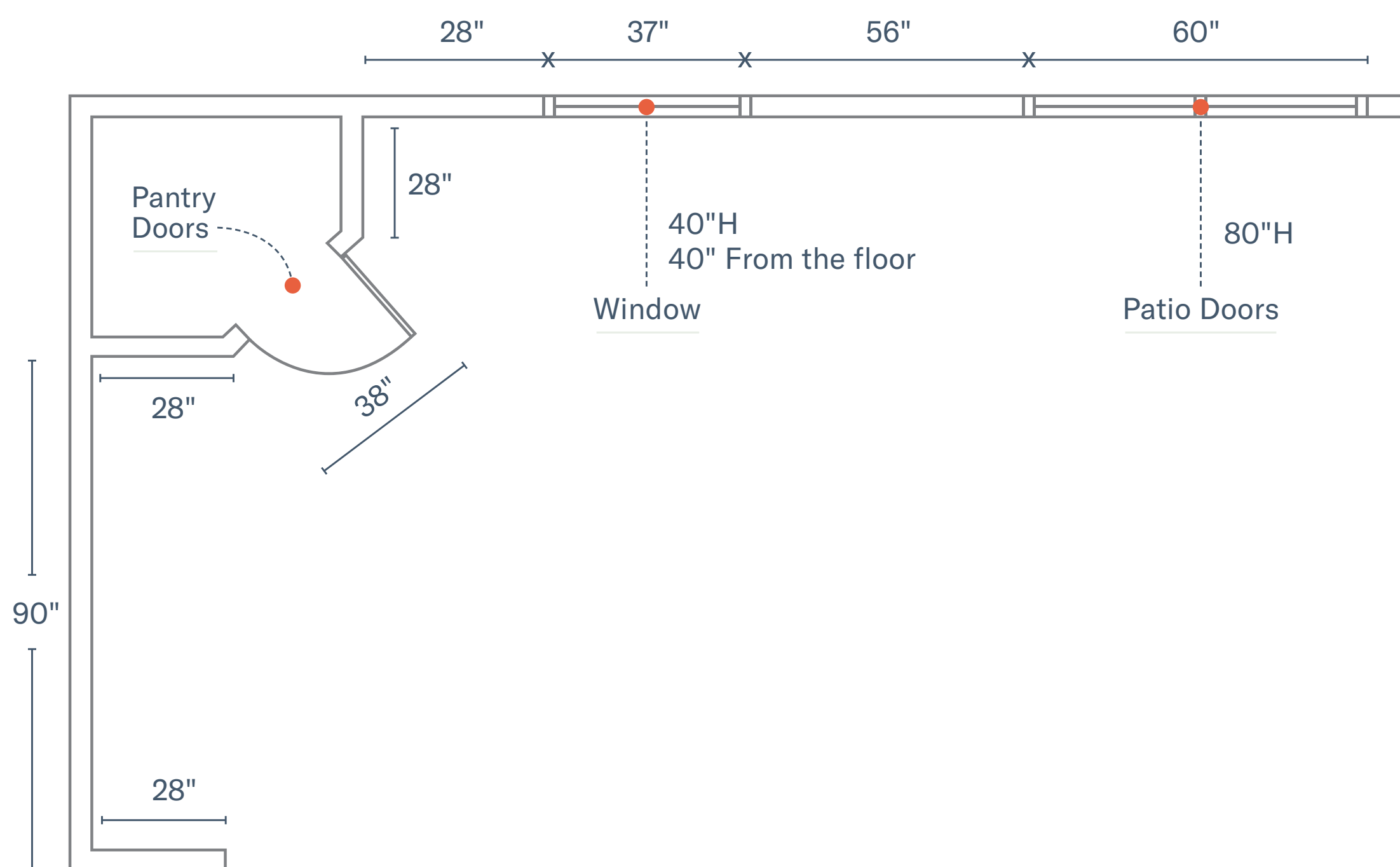

Measure all the openings from outside casing to outside casing.

Use inches and measure to the nearest  $\frac{1}{8}$  of an inch.

Working from left to right, work clockwise measuring the full length of each wall, including all windows and doorways.

## Doors and windows

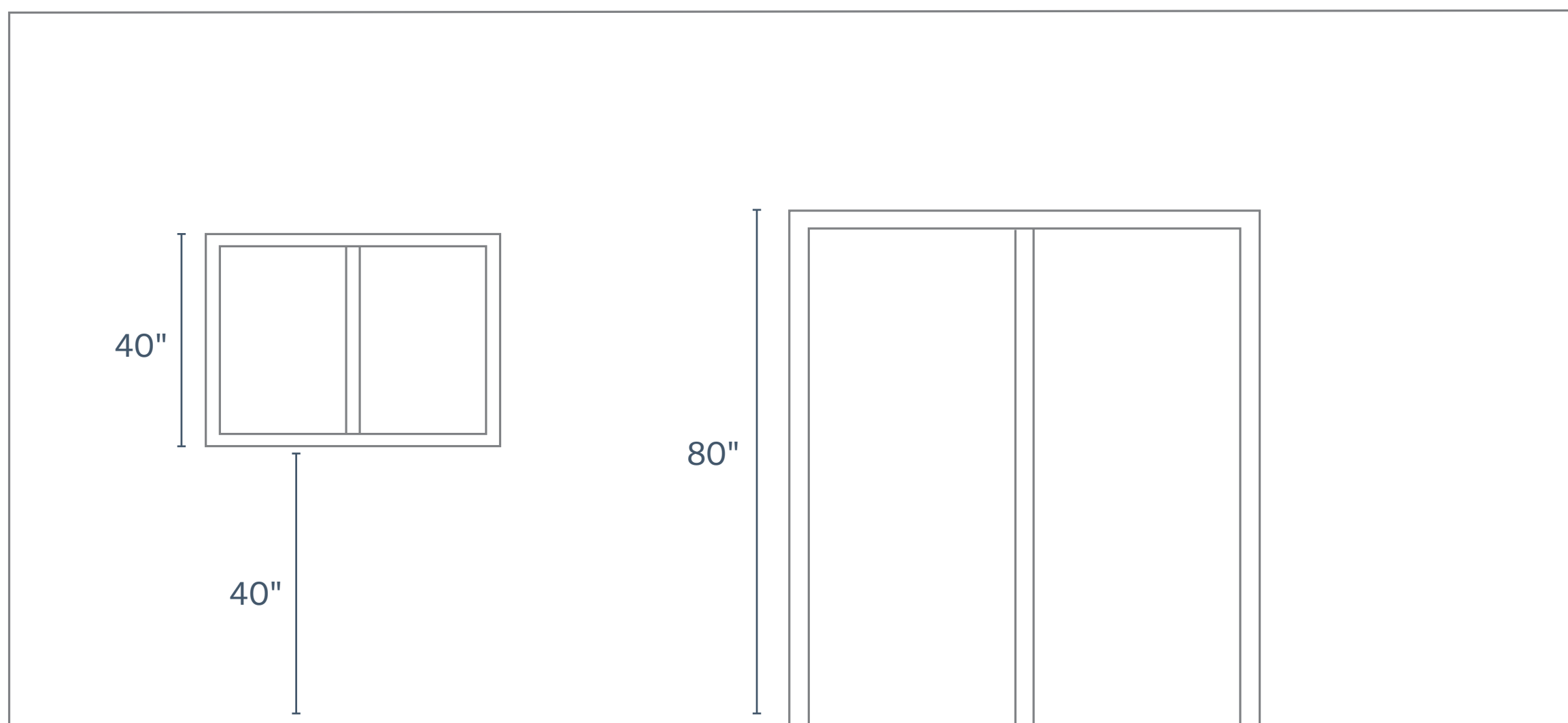

For doors, doorways, and windows, make sure to include the trim/casing in the overall measurements.

Heights of the window are also required, so you will need to measure from the bottom of the window to the floor.

## Ceiling height

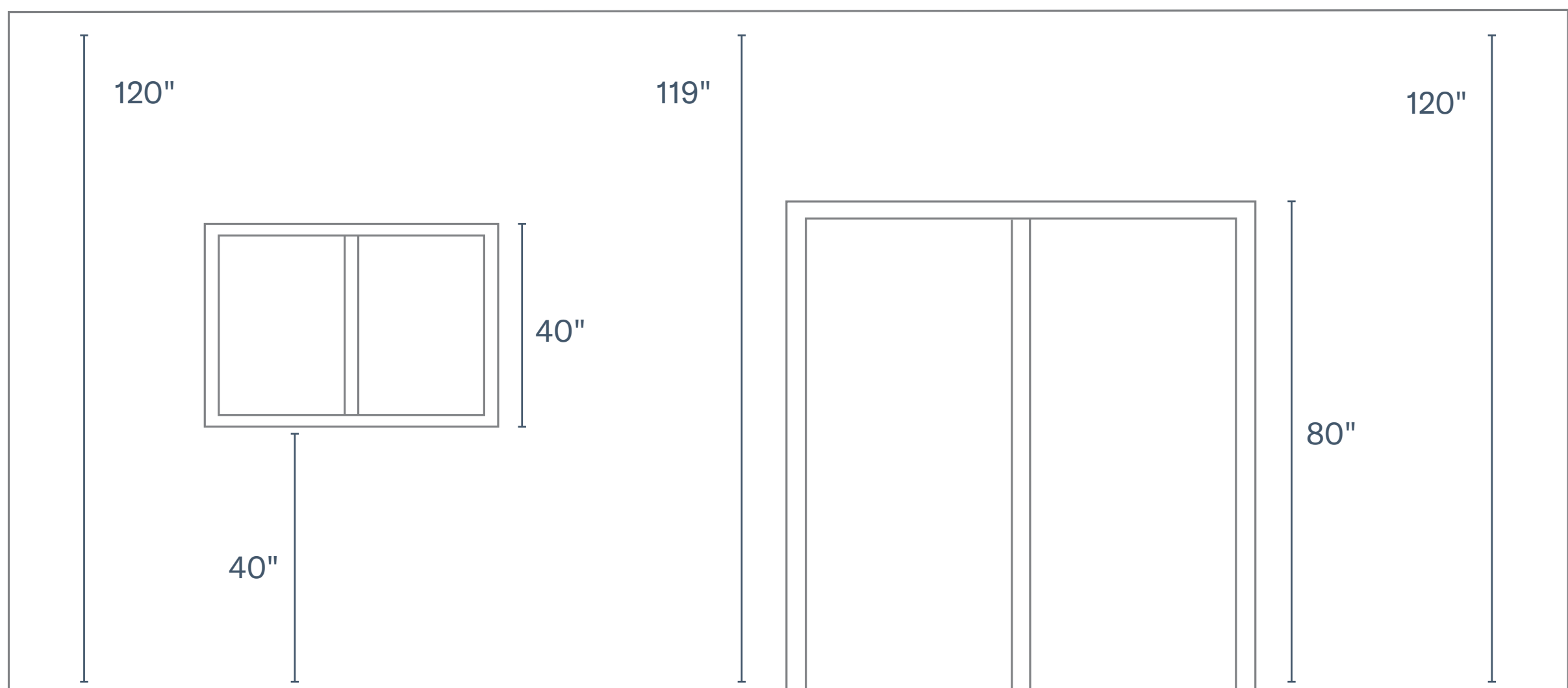

When measuring the ceiling height, measure the height at two to three places to compensate for any variations, and record these on your floor plan.

---

## Step 3: “Before” photos



What will really help your designer is to take “before” photos of your kitchen and send them along with your measurements.



## Step 4: Upload everything

**Almost done. Take a photo of your measurement drawing and upload it to the survey we sent!**



### Measurements

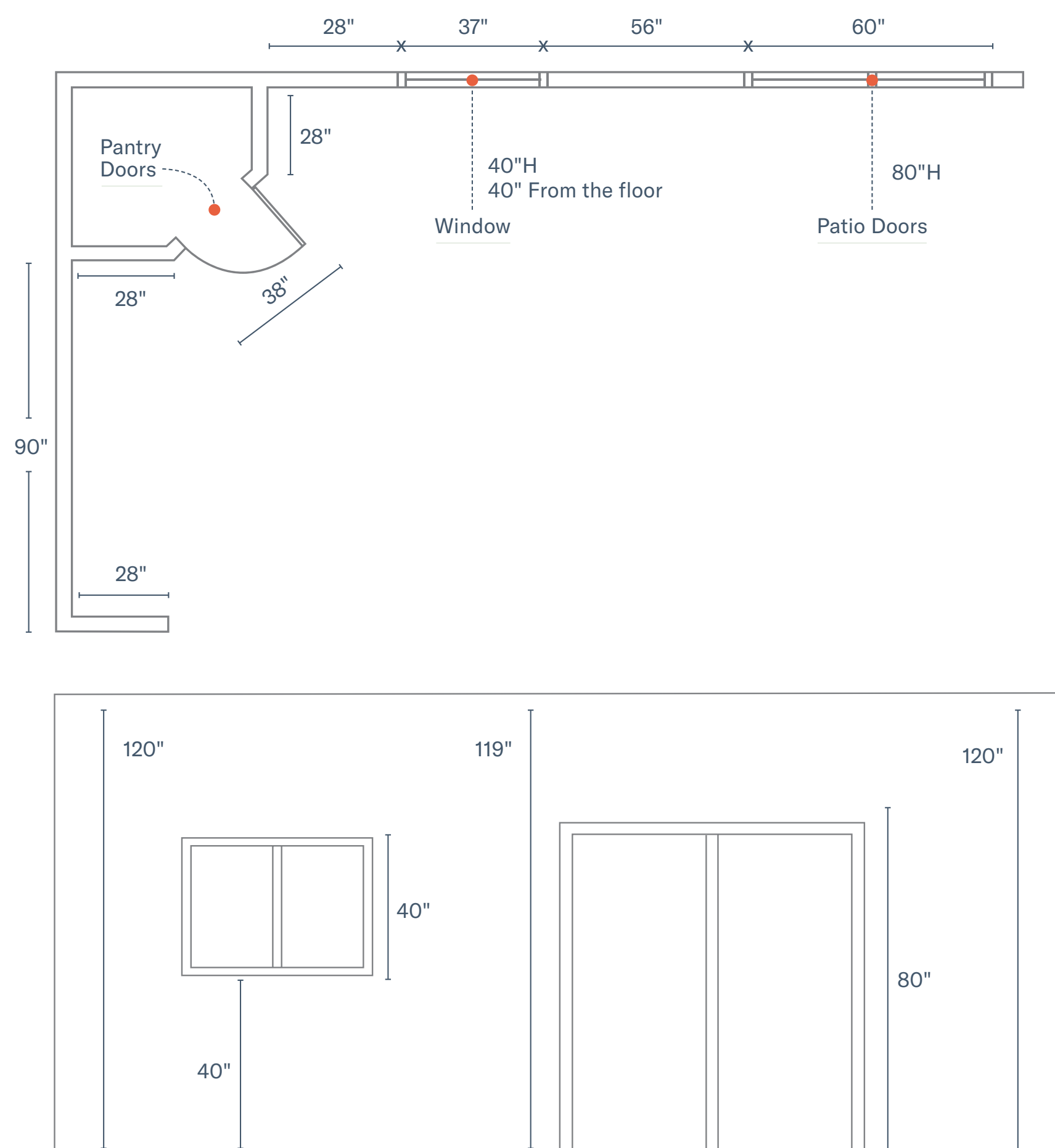





by *semihandmade*

# Home Space Made Simple

